



2HB 910

Selection and ordering data

Type 2HB 910

Curve No.	Type	Fre-quency Hz	Rated power kW	Input voltage V	Input current A	Permissible total differential pressure ²⁾		Sound pressure level ³⁾ dB(A)	Weight ca. kg
						Vacuum mbar	Compressor mbar		

3~ 50/60 Hz IP55 isulation material class F 1)

Curve No.	Type	Fre-quency Hz	Rated power kW	Input voltage V	Input current A	Vacuum mbar	Compressor mbar	Sound pressure level ³⁾ dB(A)	Weight ca. kg		
A 380	2HB 910-850T	50	8.5	345D ... 415D	600Y...720Y	18.2D	10.5Y	-190	190	74	93
A 381	2HB 910-850T	60	9.8	380D ... 480D	660Y...720Y	18.2D	10.5Y	-150	140	79	93
A 382	2HB 910-1250T	50	12.5	345D ... 415D	600Y...720Y	28.0D	16.2Y	-290	280	74	116
A 383	2HB 910-1250T	60	14.5	380D ... 480D	660Y...720Y	29.0D	16.7Y	-270	260	79	116
A 384	2HB 910-1850T	50	18.5	345D ... 415D	600Y...720Y	37.0D	21.0Y	-360	460	74	126
A 385	2HB 910-1850T	60	21.3	380D ... 480D	660Y...720Y	39.0D	22.5Y	-380	420	79	126

Type	A	B	B'	C	C'	D	E	F	F'	F''	G	H	J	K	M	N	O	P	Q	ØR	S	U	V	ØX	YxZ	W
2HB 910-850T	550	569	55	207	15	360	415	525	644	605	268	300	167	533	39	89	92	100	150	15	21	M12x30	4xM32x1.5	490	M12x30	42
2HB 910-1250T	550	569	55	207	15	360	415	611	644	605	345	300	197	533	39	89	92	100	150	15	21	M12x30	4xM40x1.5	490	M12x30	54
2HB 910-1850T	550	569	55	207	15	360	415	611	644	605	345	300	197	533	39	89	92	100	150	15	21	M12x30	4xM40x1.5	490	M12x30	54

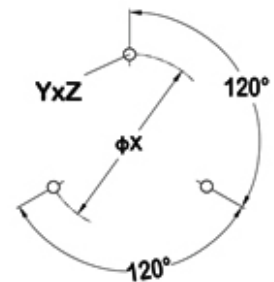
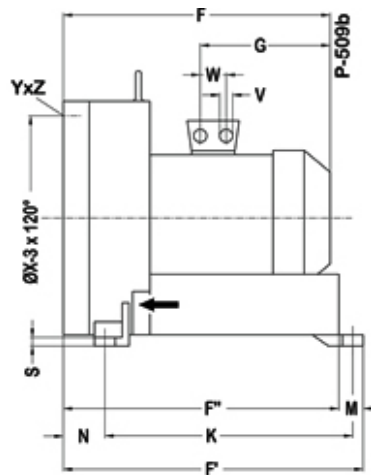
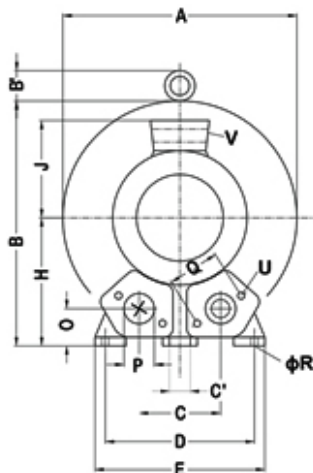

All blowers achieve the standards and norms of the low voltage directive (LVD)2006/95/EC, rotating electrotechnical motor EN 60034-1-2004, electromagnetic compatibility(EMC)EN55014-1/2,EN61000-2/-3/-4/-6.

- 1) For standard UL for ELECTRIC MOTOR UL 1004-1.
- 2) Relief-valve are available for limiting differential pressure.
- 3) Measuring-surface sound-pressure level acc. to DIN EN 21680, measured at a distance of 1 m. The pump is throttled to an average suction pressure, a hose is connected to the discharge side (compressor) / suction side (vacuum pump), but is not fitted with relief valves.

The motors are designed according to the DIN EN 60 034 / DIN IEC 34-1 and temperature class F.

For the three phase machines the tolerances are +/- 10 % for fixed voltage and +/- 5 % for voltage range.

The single phase machines are designed with a +/- 5 % tolerances. If only 90 % of the maximum allowed pressure will be used for the continuous operating then the allowed voltage range add to +/- 10 %.

For all single and three phase machines which designed according to the UL and CSA norm (UL 1004-1) the maximum allowed voltage tolerances are - 10 % resp. + 6 %.

The frequency tolerance is maximum +/- 2 %.



2HB

Performance curve for Vacuum pump

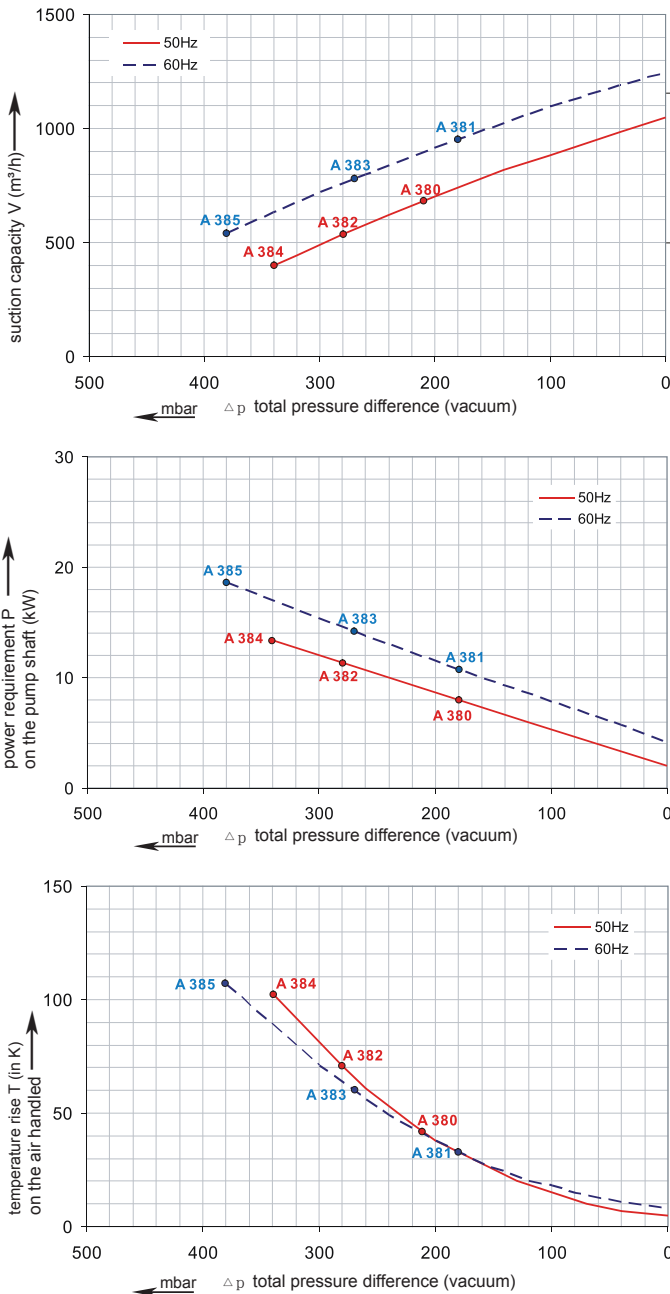

2HB 910

Performance curve for Compressor

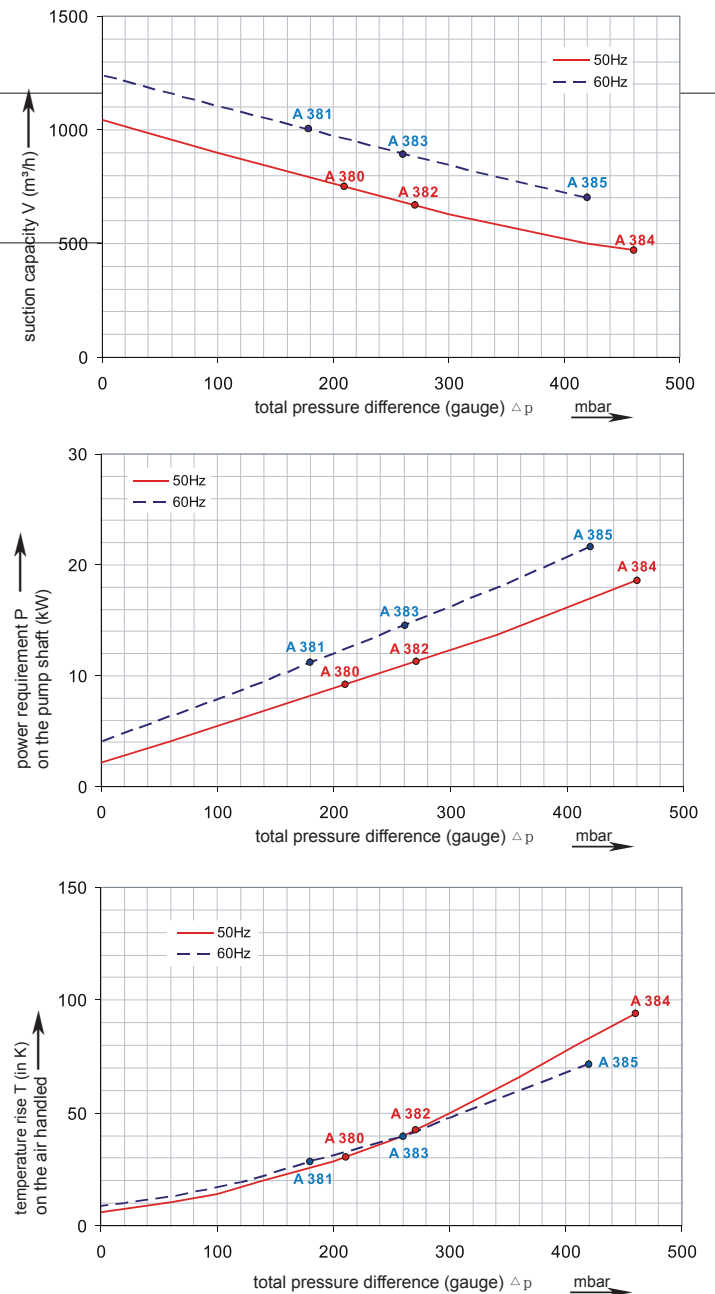

The performance curves are based on air at a temperature of 15 °C and an atmospheric pressure of 1013 mbar with a tolerance of +/- 10 %. The total pressure differences are valid for suction and ambient temperatures up to 25 °C. For other conditions please confer with us.

Each type can be applied both as vacuum pump and compressor in continuous operation over the total stated performance curve range. The motors are available as standard for the input voltage range of 50 and 60 Hz and for protection category IP 55 as well as approved for UL and CSA.