

2HB 940

Selection and ordering data

Type 2HB 940

Curve No.	Type	Fre- quency Hz	Rated power kW	Input voltage V	Input current A	Permissible total differential pressure ²⁾		Sound pressure level ³⁾ dB(A)	Weight ca. kg
						Vacuum mbar	Compressor mbar		

3~ 50/60 Hz IP55 insulation material class F 1)

A 410	HB 2940-1500T	50	15.0	345D...415D	600Y...720Y	35.0D	20.0Y	-130	110	75	187
A 411	HB 2940-1500T	60	17.5	380D...480D	660Y...720Y	36.5D	21.0Y	-60	40	84	187
A 412	HB 2940-2000T	50	20.0	345D...415D	600Y...720Y	40.0D	23.0Y	-220	200	75	212
A 413	HB 2940-2000T	60	23.0	380D...480D	660Y...720Y	42.0D	24.2Y	-160	130	84	212
A 414	HB 2940-2500T	50	25.0	345D...415D	600Y...720Y	52.0D	30.0Y	-310	270	75	219
A 415	HB 2940-2500T	60	29.0	380D...480D	660Y...720Y	52.0D	30.0Y	-270	220	84	219

Type	A	B	B'	C	C'	D	E	F	F'	G	H	J	K	M	N	O	P	Q	ØR	S	U	V	ØX	YxZ	W
HB 2940-1500T	615	657	16	207	15	360	415	752	786	345	350	197	533	39	280	152	100	140	15	71	M12x35	4xM40x1.5	490	M12x30	54
HB 2940-2000T	615	657	16	207	15	360	415	752	786	345	350	197	533	39	280	142	100	140	15	71	M12x35	4xM40x1.5	490	M12x30	54
HB 2940-2500T	615	657	16	207	15	360	415	812	786	345	350	197	533	39	280	142	100	140	15	71	M12x35	4xM40x1.5	490	M12x30	54

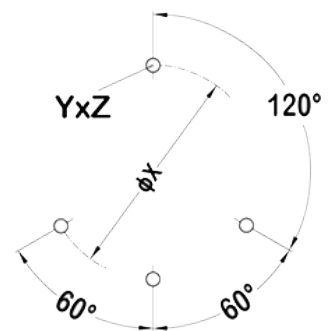
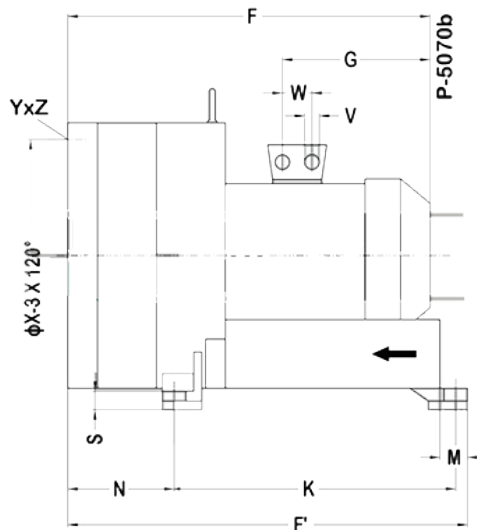
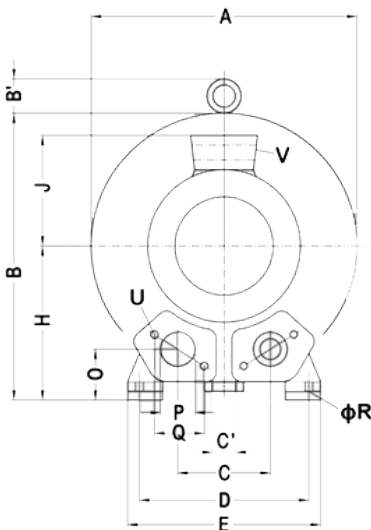

All blowers achieve the standards and norms of the low voltage directive (LVD)2006/95/EC, rotating electrotechnical motor EN 60034-1-2004, electromagnetic compatibility(EMC)EN55014-1/2,EN61000-2/-3/-4/-6.

- 1) For standard UL for ELECTRIC MOTOR UL 1004-1.
- 2) Relief-valve are available for limiting differential pressure.
- 3) Measuring-surface sound-pressure level acc. to DIN EN 21680, measured at a distance of 1 m. The pump is throttled to an average suction pressure, a hose is connected to the discharge side (compressor) / suction side (vacuum pump), but is not fitted with relief valves.

The motors are designed according to the DIN EN 60 034 / DIN IEC 34-1 and temperature class F.

For the three phase machines the tolerances are +/- 10 % for fixed voltage and +/- 5 % for voltage range.

The single phase machines are designed with a +/- 5 % tolerances. If only 90 % of the maximum allowed pressure will be used for the continuous operating then the allowed voltage range add to +/- 10 %.

For all single and three phase machines which designed according to the UL and CSA norm (UL 1004-1) the maximum allowed voltage tolerances are - 10 % resp. + 6 %.

The frequency tolerance is maximum +/- 2 %.

2HB 940

Performance curve for Vacuum pump

Performance curve for Compressor

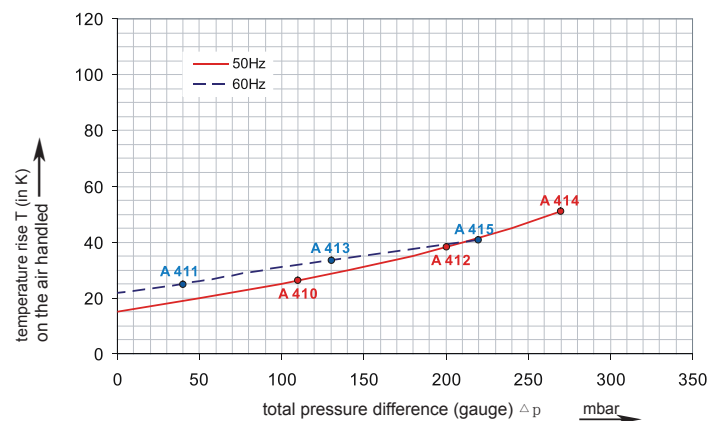
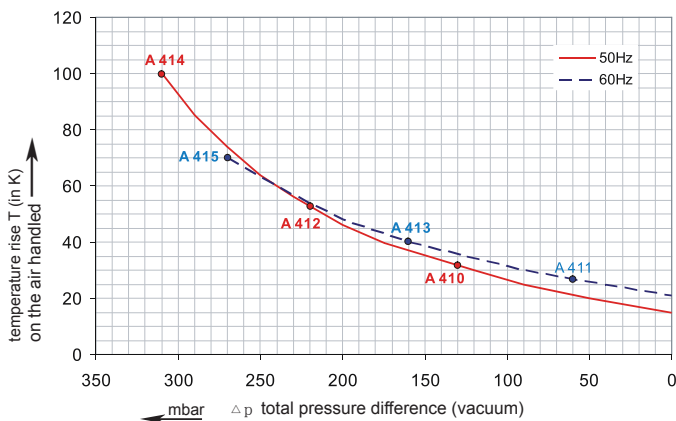
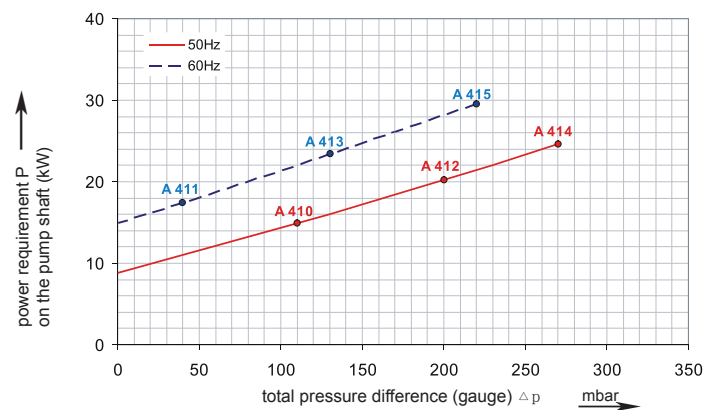
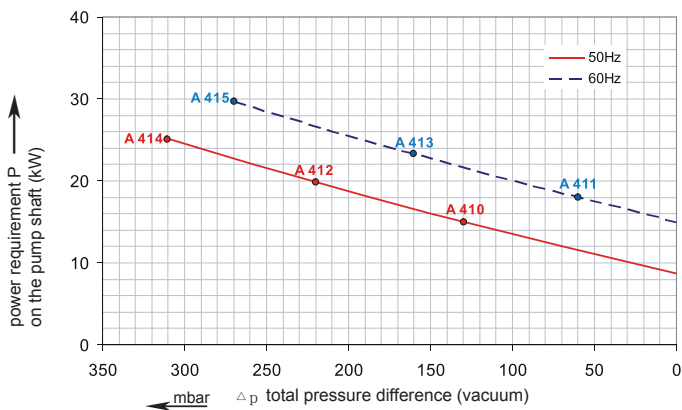
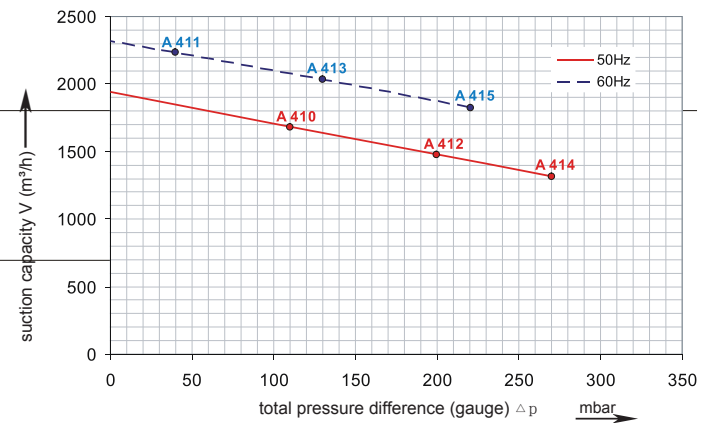
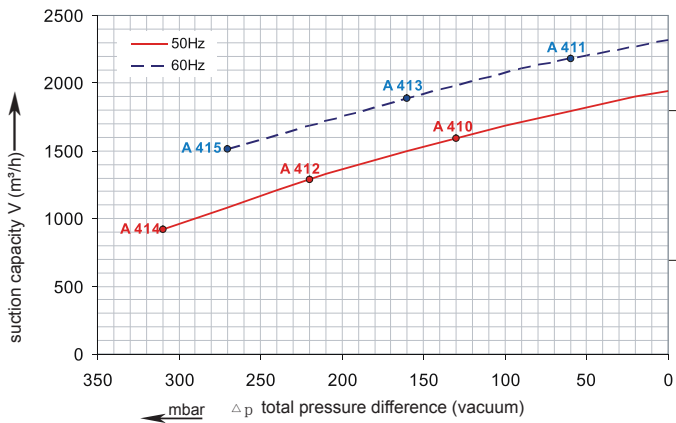

The performance curves are based on air at a temperature of 15 °C and an atmospheric pressure of 1013 mbar with a tolerance of +/- 10 %.
The total pressure differences are valid for suction and ambient temperatures up to 25 °C.
For other conditions please confer with us.

Each type can be applied both as vacuum pump and compressor in continuous operation over the total stated performance curve range. The motors are available as standard for the input voltage range of 50 and 60 Hz and for protection category IP 55 as well as approved for UL and CSA.