



## 2HB 320

### Selection and ordering data

#### Type 2HB 320

Curve No.	Type	Frequency	Rated power	Input voltage	Input current	Permissible total differential pressure <sup>2)</sup>		Sound pressure level <sup>3)</sup>	Weight ca.
						Vacuum mbar	Compressor mbar		
		Hz	kW	V	A			dB(A)	kg

#### 3~ 50/60 Hz IP55 insulation material class F 1)

A 170	2HB 320-085T	50	0.85	200D ... 240D	345Y...415Y	4.2D	2.4Y	-200	230	58	17
A 171	2HB 320-085T	60	0.95	220D ... 275D	380Y...480Y	4.0D	2.3Y	-240	240	60	17
A 172	2HB 320-130T	50	1.3	200D ... 240D	345Y...415Y	5.7D	3.3Y	-280	290	58	18
A 173	2HB 320-130T	60	1.5	220D ... 275D	380Y...480Y	6.0D	3.5Y	-300	400	60	18

#### 1~ 50/60 Hz IP55 with attached condenser for continuous operation

A 170s	2HB 320-110S	50	1.1	230		7.3		-240	280	58	17
A 171s	2HB 320-110S	60	1.3	230		8.3		-230	260	60	17

Type	A	A'	B	C	D	E	F	G	H	H'	J	K	L	M	N	O	P	Q	φR	S	T	U	V <sub>(-)</sub>	V <sub>(+)</sub>	φX	YxZ
2HB 320-085T	294	324	286	47	205	230	354	160	141	114	120	83	108	82	138	41	1 ¼	64	10	2,5	92	M6x17	M25x1.5	M16x1.5	140	M6x15
2HB 320-130T	294	324	286	47	205	230	354	160	141	114	120	83	108	82	138	41	1 ¼	64	10	2,5	92	M6x17	M25x1.5	M16x1.5	140	M6x15
2HB 320-110S	294	324	286	47	205	230	354	160	141	114	120	83	108	82	138	41	1 ¼	64	10	2,5	92	M6x17	M25x1.5	M16x1.5	140	M6x15

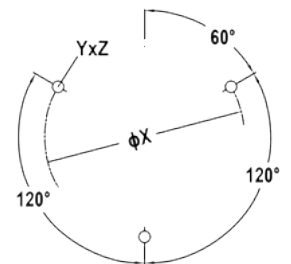
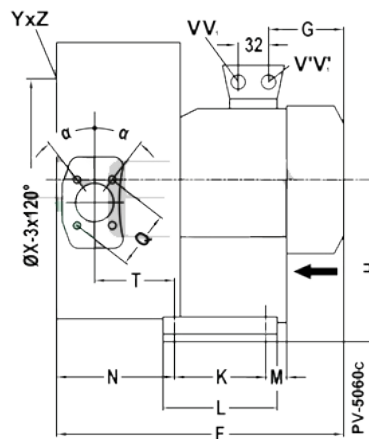
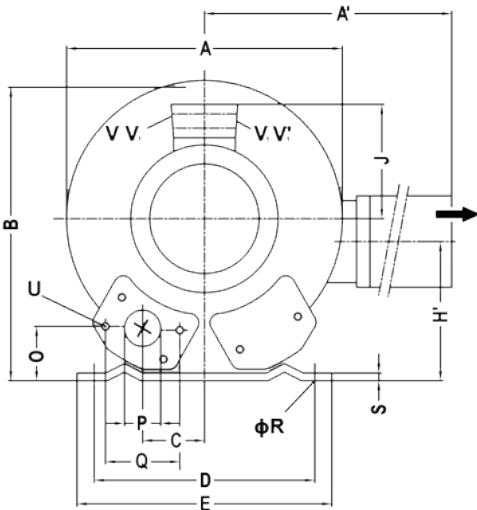

All types achieve the standards and norms of the low voltage directive (LVD)2006/95/EC, rotating electrotechnical motor EN 60034-1-2004, electromagnetic compatibility(EMC)EN55014-1/2,EN61000-2/-3/-4/-6.

- 1) For standard UL for ELECTRIC MOTOR UL 1004-1.
- 2) Relief-valve are available for limiting differential pressure.
- 3) Measuring-surface sound-pressure level acc. to DIN EN 21680, measured at a distance of 1 m. The pump is throttled to an average suction pressure, a hose is connected to the discharge side (compressor) / suction side (vacuum pump), but is not fitted with relief valves.

The motors are designed according to the DIN EN 60 034 / DIN IEC 34-1 and temperature class F.

For the three phase machines the tolerances are +/- 10 % for fixed voltage and +/- 5 % for voltage range.

The single phase machines are designed with a +/- 5 % tolerances. If only 90 % of the maximum allowed pressure will be used for the continuous operating then the allowed voltage range add to +/- 10 %.

For all single and three phase machines which designed according to the UL and CSA norm (UL 1004-1) the maximum allowed voltage tolerances are - 10 % resp. + 6 %.

The frequency tolerance is maximum +/- 2 %.

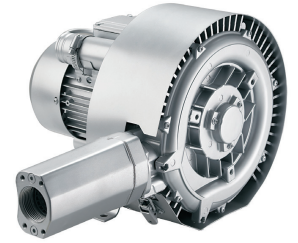

## 2HB 320

Performance curve for Vacuum pump

Performance curve for Compressor

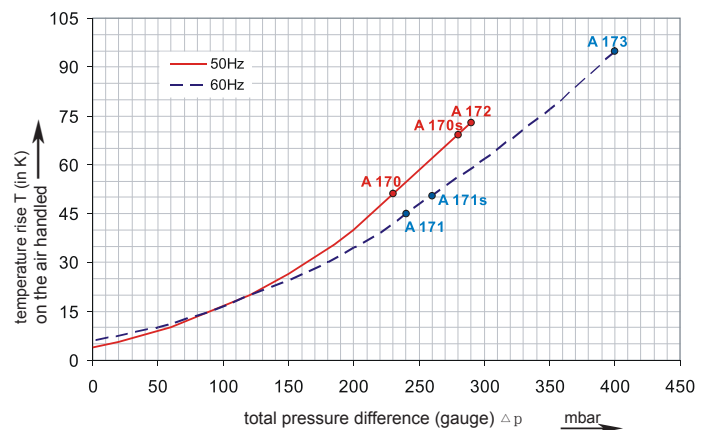
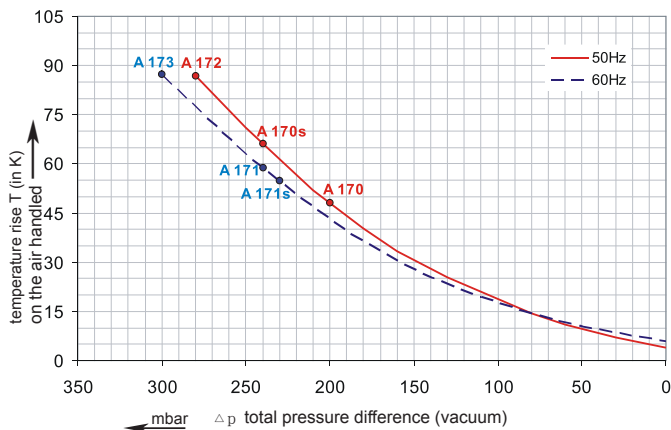
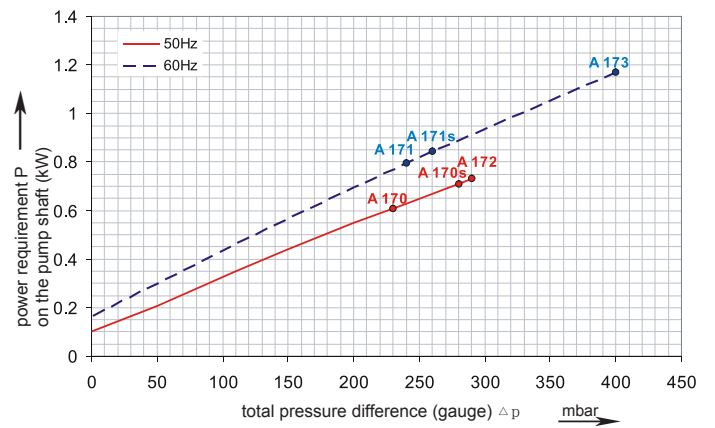
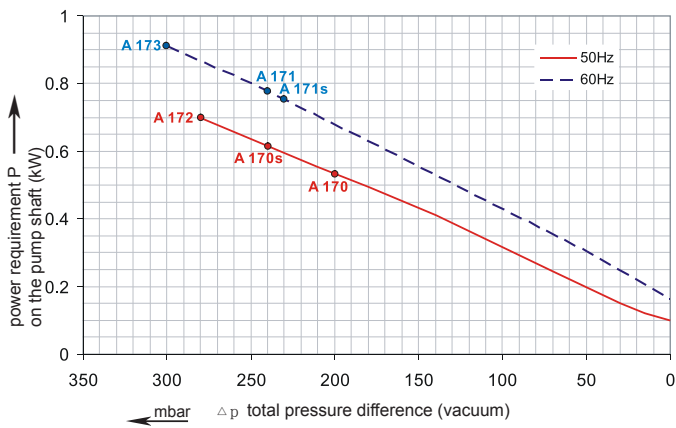
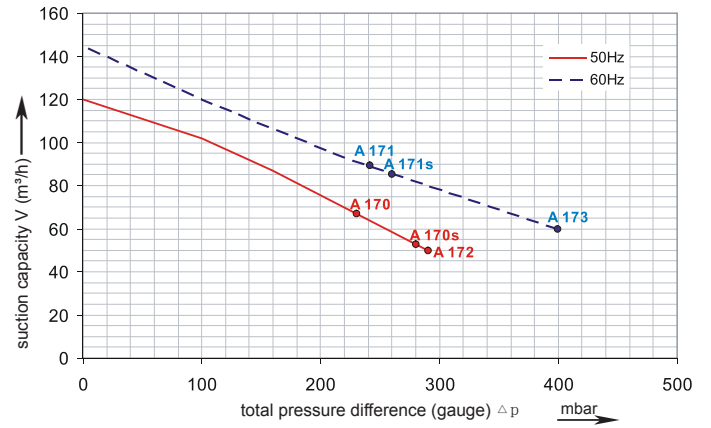
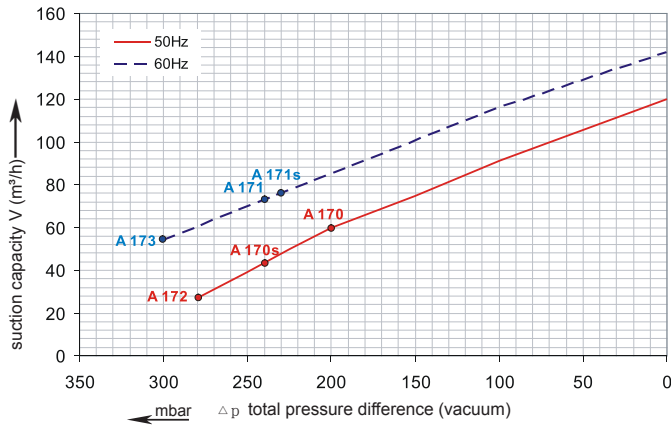

The performance curves are based on air at a temperature of 15 °C and an atmospheric pressure of 1013 mbar with a tolerance of +/- 10 %. The total pressure differences are valid for suction and ambient temperatures up to 25 °C. For other conditions please confer with us.

Each 2HB type can be applied both as vacuum pump and compressor in continuous operation over the total stated performance curve range. The motors are available as standard for the input voltage range of 50 and 60 Hz and for protection category IP 55 as well as approved for UL and CSA.